



Installation Instructions

AeroSun EVO IV



AeroLEDs, LLC
 8475 W. Elisa St.
 Boise, ID, 83709
 208-850-3294

NOTE: A printed copy of this document may not be the latest revision. It is the responsibility of the user to ensure that the latest revision is used. The latest revision of this document may be printed from the AeroLEDs electronic document repository. Revision history follows on page 2

This document contains proprietary information of AeroLEDs. Neither receipt nor possession thereof confer any right to reproduce or use, or disclose, in whole or in part, any such information without written permission from AeroLEDs.

Approval	Name	Intent	
Author	Ryan Edmark	Installation and Operation Instructions for the AeroSun EVO IV Landing Light	
Check	Nate Calvin		
Quality	Mark McCormack		
Date:	28 June 2024		
Status: Released	Typed signatures indicate approval. Handwritten, or electronic signature approval of this document is on file at AeroLEDs, Boise, Idaho.	Document Number 0100-0003	Revision C

REVISION RECORD

Rev	Description	Date	Author
C	All pages revised and format update	06/28/2024	R. Edmark
B	All pages revised	03/26/2018	J. Blanchfield
A	Singular page revised	03/28/2017	D. Wilkinson
IR	Original Version	06/30/2016	D. Wilkinson

TABLE OF CONTENTS

1	System Description	4
2	Model Numbers	4
3	Instructions for Continued Airworthiness.....	4
4	Periodic Inspections.....	4
5	Installation.....	5
5.1	Installation Procedures.....	5
5.2	Troubleshooting.....	5
5.3	Installation Options.....	6
6	Wiring Diagrams	8
6.1	Wiring Diagram for Single AeroSun EVO IV	8
6.2	Wiring Diagram for Dual AeroSun EVO IV	8
6.3	Wiring Diagram for Four AeroSun EVO IV	9

1 System Description

The AeroSun EVO IV Series landing light is a rectangular shape LED to fit a variety of experimental and LSA platforms. It features integrated Pulse or “WigWag”, significantly increasing recognition in broad daylight as well as night operations to help avoid midair collisions and bird strikes while drawing half the current.

2 Model Numbers

Model	Part Number	Description	Voltage (V)	Current (Amps)	Power (W)	Weight (oz)
AeroSun EVO IV	01-2120	Landing w/Pulse	9-30	3.4@ 14VDC	48	9.6
				1.7@ 28VDC		

3 Instructions for Continued Airworthiness

AeroSun EVO IV series LED landing light assembly contains no user serviceable items. Should any LED fail, unit must be replaced.

4 Periodic Inspections

Interval	Inspection	Remedy	Notes
Pre-Flight	<ul style="list-style-type: none">Perform a functional check and observe that all LEDs are illuminated.	<ul style="list-style-type: none">If all LEDs are not illuminated replace light as soon as is practicable.	<ul style="list-style-type: none">Lights are not user serviceable.Lights are very bright and to reduce eye strain during inspection use an optical filter such as dark glasses or welding goggles.
Annually, unless the OEM specifies a shorter interval	<ul style="list-style-type: none">Perform a functional check and observe that all LEDs are illuminated.Check mounting, connections, and wire integrity	<ul style="list-style-type: none">If all LEDs are not illuminated, the light must be replaced.Adjust or replace wiring, and connectors as required	

5 Installation

Consult **14CFR, §43.13-1B** for guidance on acceptable methods, techniques, and practices. For retrofit installation existing circuit breaker or fuse may typically be used. Procedures contained herein are not intended to conflict with procedures set forth by aircraft OEM, nor do they supersede FAA manuals and FAA regulations.

5.1 Installation Procedures

1. This installation procedure is for single or multiple light installations (wiring diagrams provided).
2. Pulse function is a self-contained feature and does not require use of external control circuitry. An additional wire and switch will be required to enable pulse mode, and for multiple lights an additional synchronization wire installation will be required.
3. Refer to aircraft manufacturer's service manual and/or illustrated parts catalog to identify landing and/or taxi light system installed in your aircraft. This will provide information on location of components and assembly details
4. Mount LED light with a minimum 4-inch clearance to exhaust system components unless adequate heat shielding is utilized to block radiant heat.
5. Reference airframe manufacturer's current maintenance manual and install LED light(s) in brackets using retained hardware
6. Install suitable aircraft approved connectors or splices to connect landing light assemblies to wires routed from switch in accordance with wiring diagram(s).
 - a. Yellow wire is used to power pulse mode. Follow wiring diagrams for connecting blue and green synchronization wires for two and four light installations.
 - b. Install an appropriate aircraft approved switch and circuit breaker of correct rating for lights installed for pulse function. Original landing light switch/switches may be used.
7. Verify proper operation of LED light(s), in both steady-on and pulse functions (as appropriate to installation)
8. Verify light angle is oriented & aimed in accordance with manufacturer's instructions (if applicable)
9. Reinstall associated light hardware IAW aircraft maintenance manual
10. Record installation with appropriate logbook entry (if applicable)

Note: The use of shielded cable is recommended although not required for installation.

It is recommended that ground connections for all lights be made at a single location on aircraft central ground bus. This "single point ground" scheme helps to eliminate ground loops and ground bounce that can occur when using airframe as a ground.

5.2 Troubleshooting

1. Check for proper voltage at power input wire to light
2. Ensure light is adequately grounded
3. Check for continuity in wiring and connections
4. If wiring is verified, remove light and bench-check with appropriately sized power supply

5.3 Installation Options

5.3.1 Optional Mount (KIT-0012)

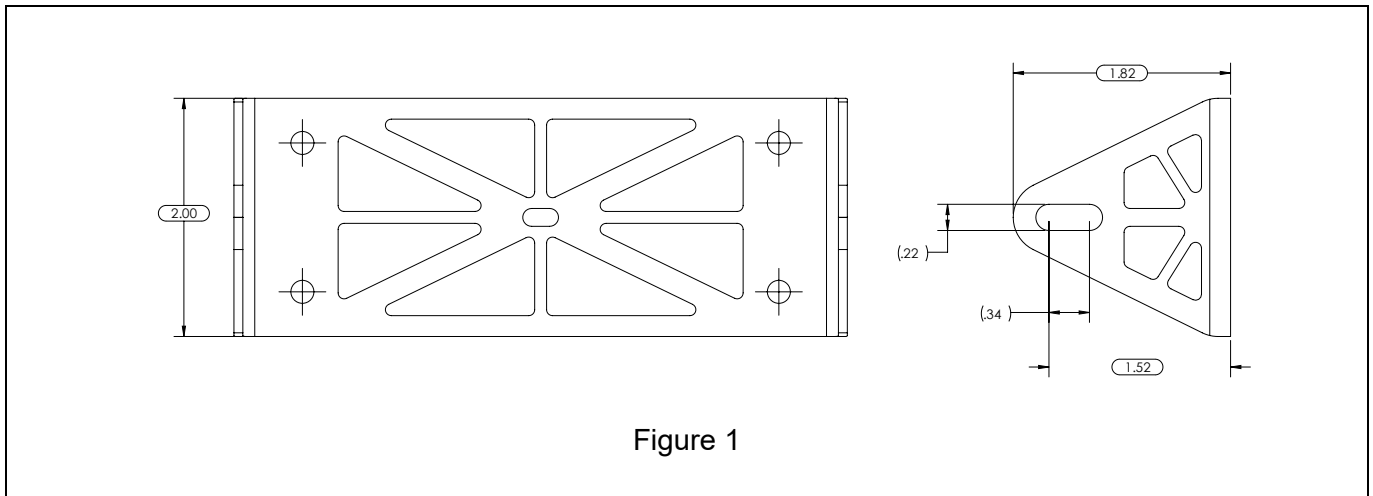

Figure 1

5.3.2 Optional Mount Installation

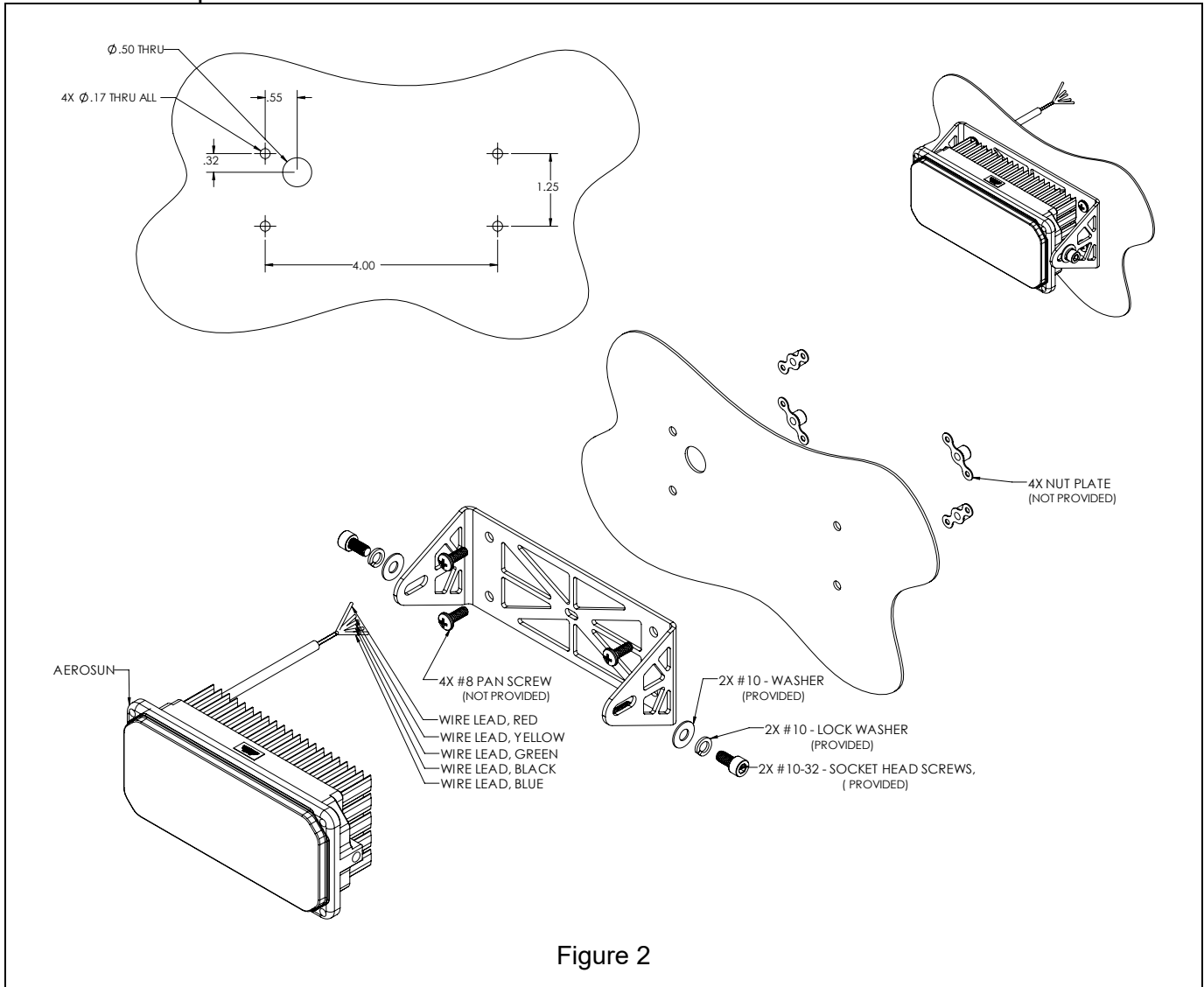

Figure 2

5.3.3 Panel Mount Installation

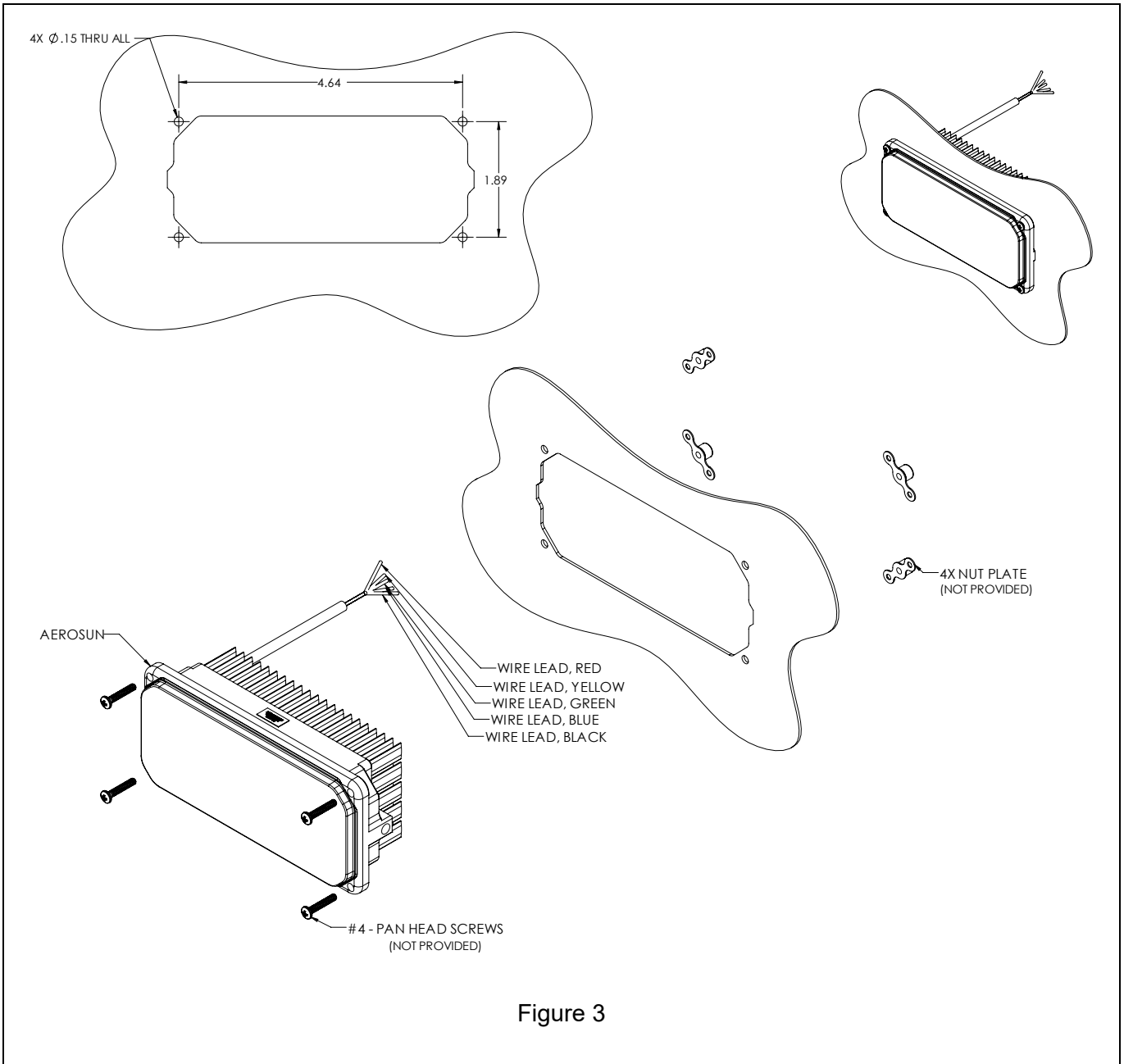

Figure 3

6 Wiring Diagrams

6.1 Wiring Diagram for Single AeroSun EVO IV

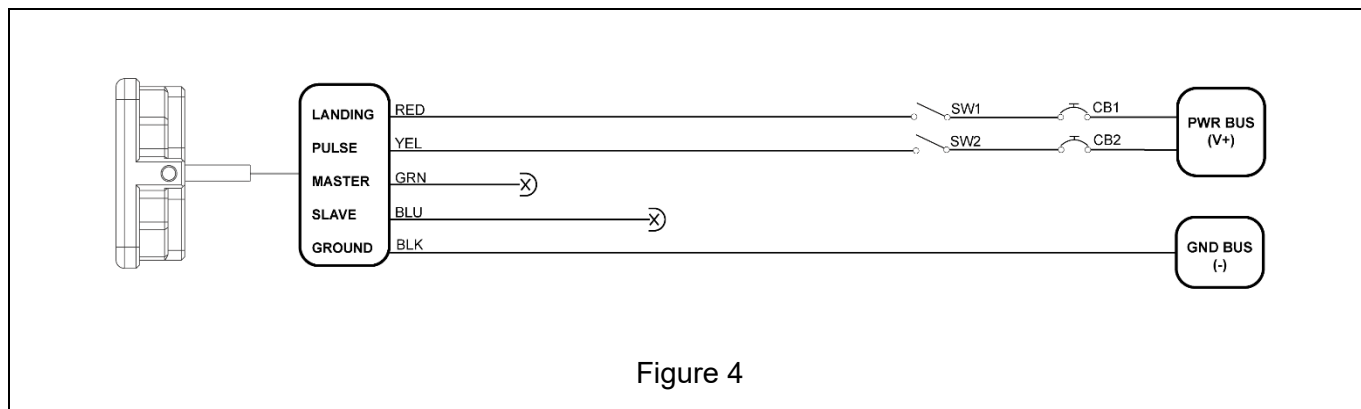

Figure 4

Fuse/breaker should be rated for wire size per **AC43.13-1B**

6.2 Wiring Diagram for Dual AeroSun EVO IV

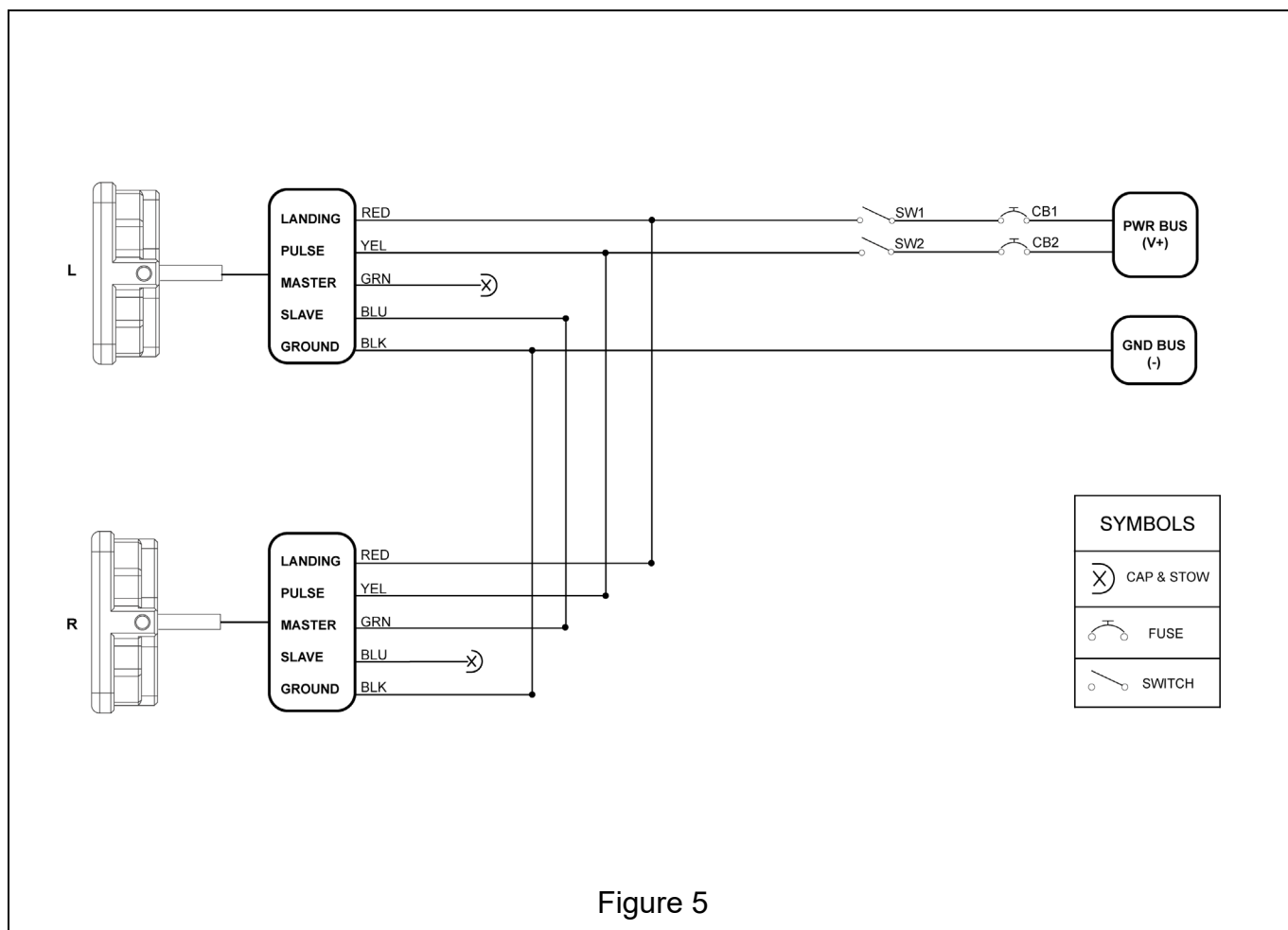

Figure 5

Fuse/breaker should be rated for wire size per **AC43.13-1B**

Note: If lights installed in close approximation, within two feet, then use AeroLEDs synch circuit (00-8120).

6.3 Wiring Diagram for Four AeroSun EVO IV

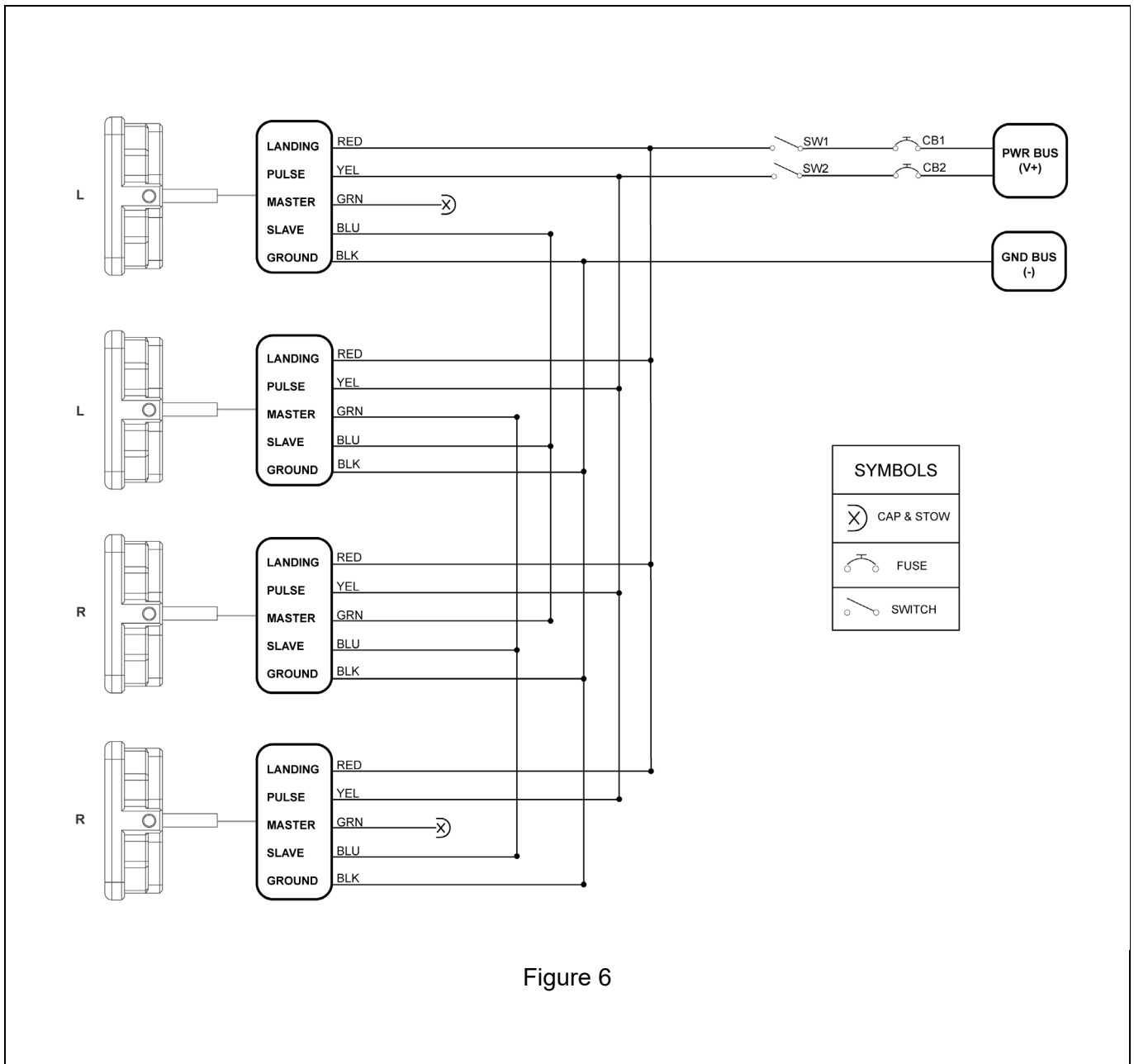

Figure 6

Fuse/breaker should be rated for wire size per AC43.13-1B